

KEL 24

Cable entry frames



Split inserts



Surrounding tongue and groove connection

Description	Type	Order No.	Inserts KT		PU
			small	large	

Product description

The KEL-24 matches exactly the cut-out dimensions of 24-pole standard industrial connectors.

The split insert matching the cable diameter is placed around the cable and inserted into the cable entry frame.

Either a cut out of 36mm or 46mm tall can be chosen depending on the cables being routed. This flexibility is perfect for pre-terminated cables.

Advantages

- Warranty of pre-terminated cables remains
- Retrofitting and maintenance can be carried out easily and quickly
- High packing density, wide variety of frames and inserts
- Strain relief according DIN EN 50262

Specification

Material	Polyamide
Flame class	UL-94 Vo, self-extinguishing
Protection class	IP 54, with gasket and correct selection of the cable inserts
Temperature	- 40°C to + 140°C (static)
Properties	halogen-free, silicone-free
Cut-out dimensions	36 x 112 mm / page 106

Accessories

KT Cable inserts	Page 20 24
KEL-SNAP SNAP frames	Page 15
KEL-EMC Cable collector	Page 82 84
KDR2 KDR Base plates	Page 90 93
FP Flanged plates	Page 94 97
MP Module plates	Page 98

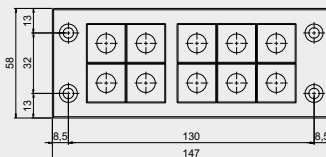

KEL 24 | 10

42241

10 | -

10

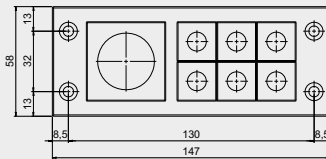

KEL 24 | 7

42247

6 | 1

10

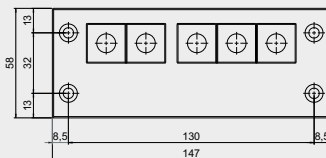

KEL 24 | 5

42248

5 | -

10

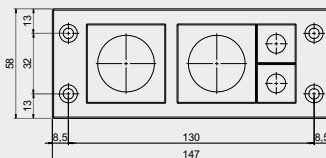

KEL 24 | 4

42244

2 | 2

10

KEL 16

Cable entry frames



Surrounding tongue and groove connection



Split inserts



Type	Order No.	Inserts KT small large	PU	Description
------	-----------	-----------------------------	----	-------------

KEL 16 8	42168	8 -	10	
KEL 16 5	42165	4 1	10	
KEL 16 4	42164	4 -	10	
KEL 16 2	42162	- 2	10	

Product description

The KEL-16 matches exactly the cut-out dimensions of 16-pole standard industrial connectors.

The split insert matching the cable diameter is placed around the cable and inserted into the cable entry frame.

Either a cut out of 36mm or 46mm tall can be chosen depending on the cables being routed. This flexibility is perfect for pre-terminated cables.

Advantages

- Warranty of pre-terminated cables remains
- Retrofitting and maintenance can be carried out easily and quickly
- High packing density, wide variety of frames and inserts
- Strain relief according DIN EN 50262

Specification

Material	Polyamide
Flame class	UL-94 V0, self-extinguishing
Protection class	IP 54, with gasket and correct selection of the cable inserts
Temperature	- 40°C to + 140°C (static)
Properties	halogen-free, silicone-free
Cut-out dimensions	36 x 86 mm / page 106

Accessories

KT Cable inserts	Page 20 24
KEL-SNAP SNAP frames	Page 15
KEL-EMC Cable collector	Page 82 84
KDR Base plates	Page 92 93

KEL 10

Cable entry frames



Split inserts



Surrounding tongue and groove connection

1

Product description

The KEL-10 matches exactly the cut-out dimensions of 10-pole standard industrial connectors.

The split insert matching the cable diameter is placed around the cable and inserted into the cable entry frame.

Either a cut out of 36mm or 46mm tall can be chosen depending on the cables being routed. This flexibility is perfect for pre-terminated cables.

Advantages

- Warranty of pre-terminated cables remains
- Retrofitting and maintenance can be carried out easily and quickly
- High packing density, wide variety of frames and inserts
- Strain relief according DIN EN 50262

Specificationen

Material	Polyamide
Flame class	UL-94 Vo, self-extinguishing
Protection class	IP 54, with gasket and correct selection of the cable inserts
Temperature	- 40°C to + 140°C (static)
Properties	halogen-free, silicone-free
Cut-out dimensions	36 x 65 mm / page 106

Accessories

KT Cable inserts	Page 20 24
KEL-SNAP SNAP frames	Page 15
KEL-EMC Cable collector	Page 83 84

Descripton	Type	Order No.	Inserts KT small large	PU
	KEL 10 6	42216	6 -	10
	KEL 10 3	42212	2 1	10

KEL - B

Cable entry frames



Surrounding tongue and groove connection



Split inserts



Product description

The KEL-B matches exactly the cut-out dimensions of 46 x 46 mm measuring instruments.

The split insert matching the cable diameter is placed around the cable and inserted into the cable entry frame.

For routing cables and conduits up to 34 mm diameter.

Advantages

- Warranty of pre-terminated cables remains
- Retrofitting and maintenance can be carried out easily and quickly
- Space saving shape
- Small cut-out, high packing density
- Strain relief according DIN EN 50262

Specification

Material	Polyamide
Flame class	UL-94 Vo, self-extinguishing
Protection class	IP 54, with gasket and correct selection of the cable inserts
Temperature Properties	- 40°C to + 140°C (static)
Cut-out dimensions	halogen-free, silicone-free
	46 x 46 mm / page 106

Accessories

KT Cable inserts	Page 20 24
KEL-SNAP SNAP frames	Page 15
KEL-EMC Cable collector	Page 83 84

Type	Order No.	Inserts KT small large	PU	Description
KEL - B4	42204	4 -	10	
KEL - B1	42206	- 1	10	